

Sunday - March 14, 2021
Judge: Debby Wheeler

TIME 2 BEAT
Keeshond Club of Southern Ca

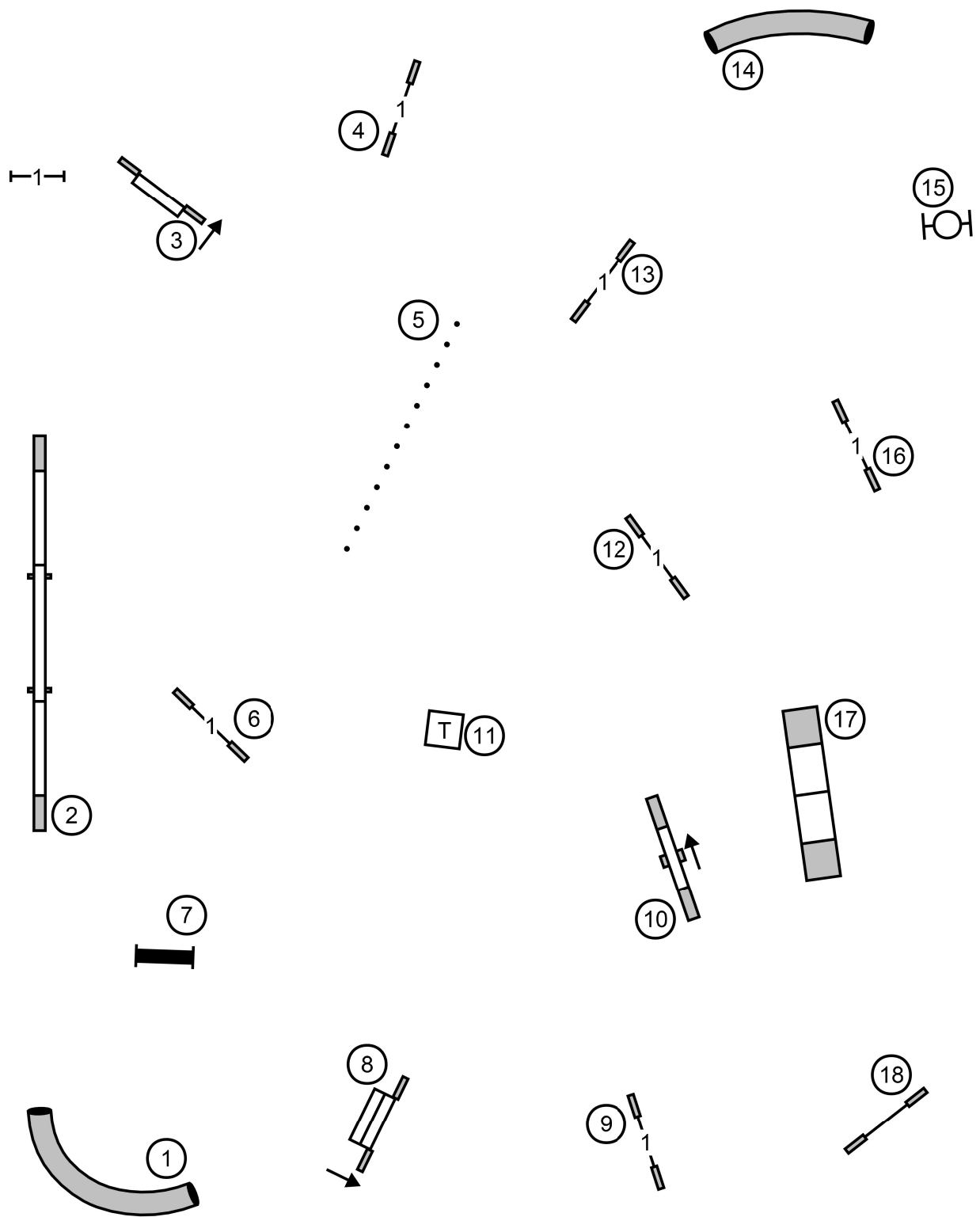

Next Dog in at #14

ENTRY

EXIT

Sunday - March 14, 2021
Judge: Debby Wheeler

EXCELLENT MASTER STANDARD
Keeshond Club of Southern Ca

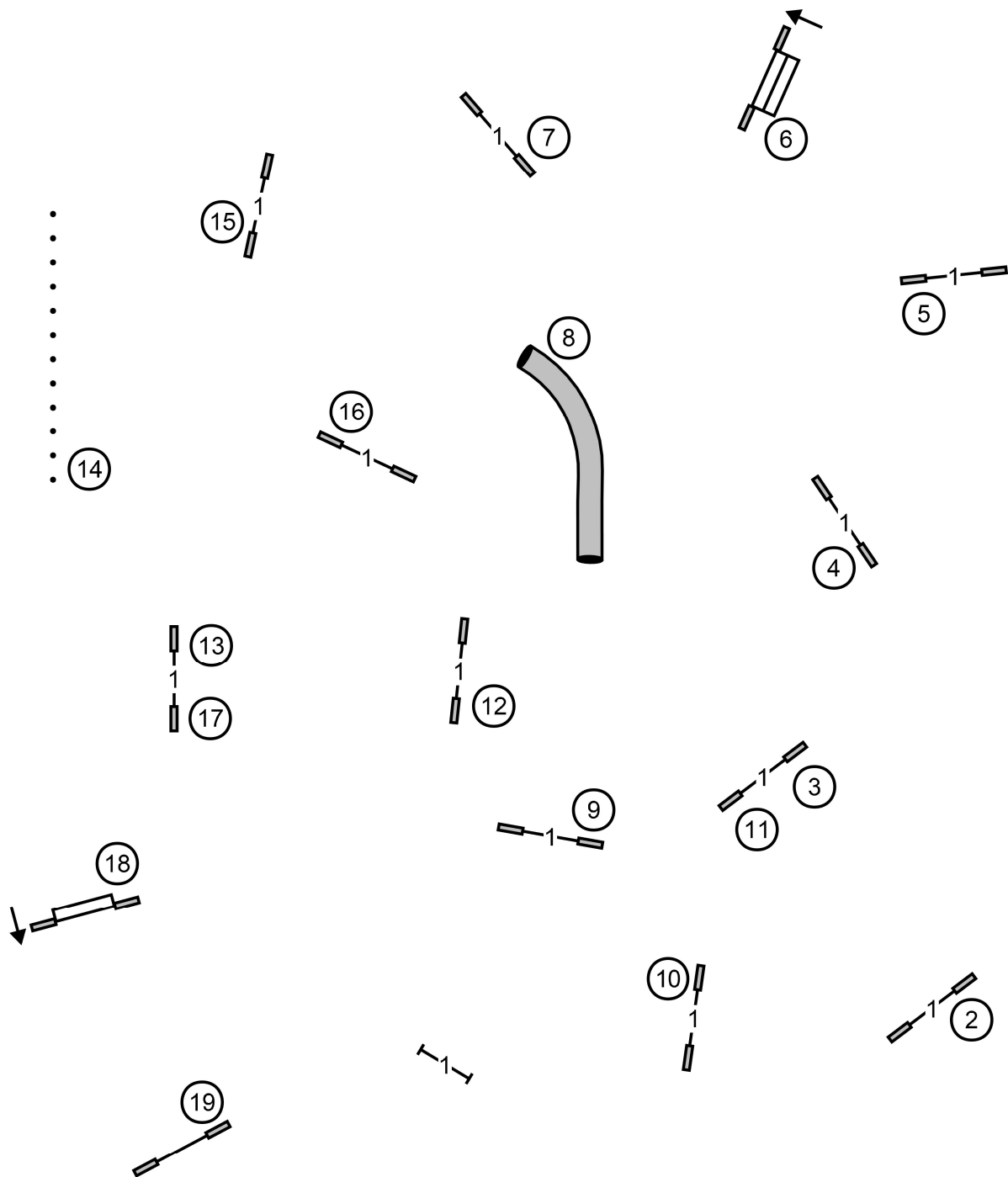

Next Dog in at #15

EXIT

ENTRY

Sunday - March 14, 2021
Judge: Debby Wheeler

EXCELLENT MASTER JWW
Keeshond Club of Southern Ca

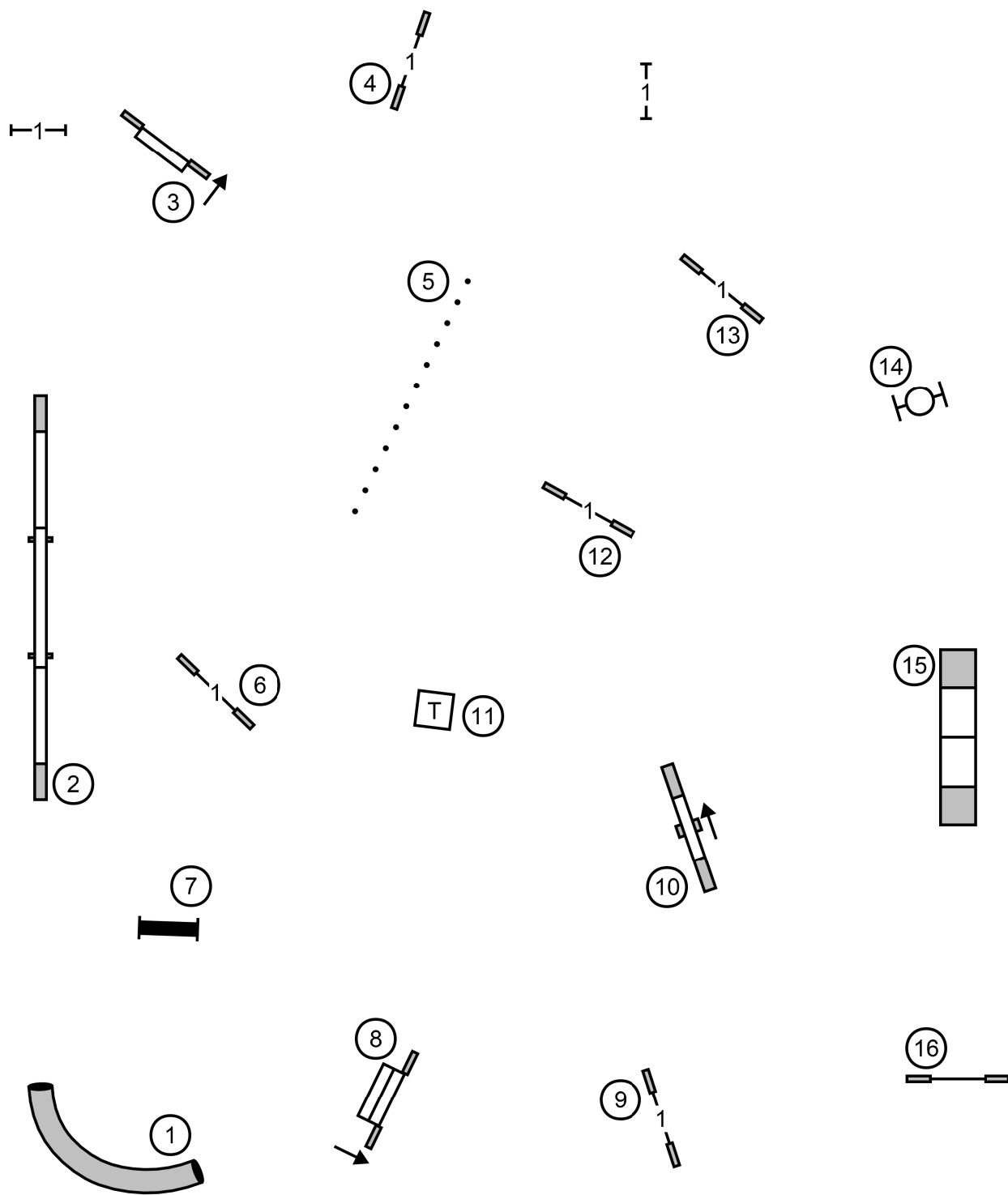

Next Dog in at #13

ENTRY

EXIT

Sunday - March 14, 2021
Judge: Debby Wheeler

OPEN STANDARD
Keeshond Club of Southern Ca

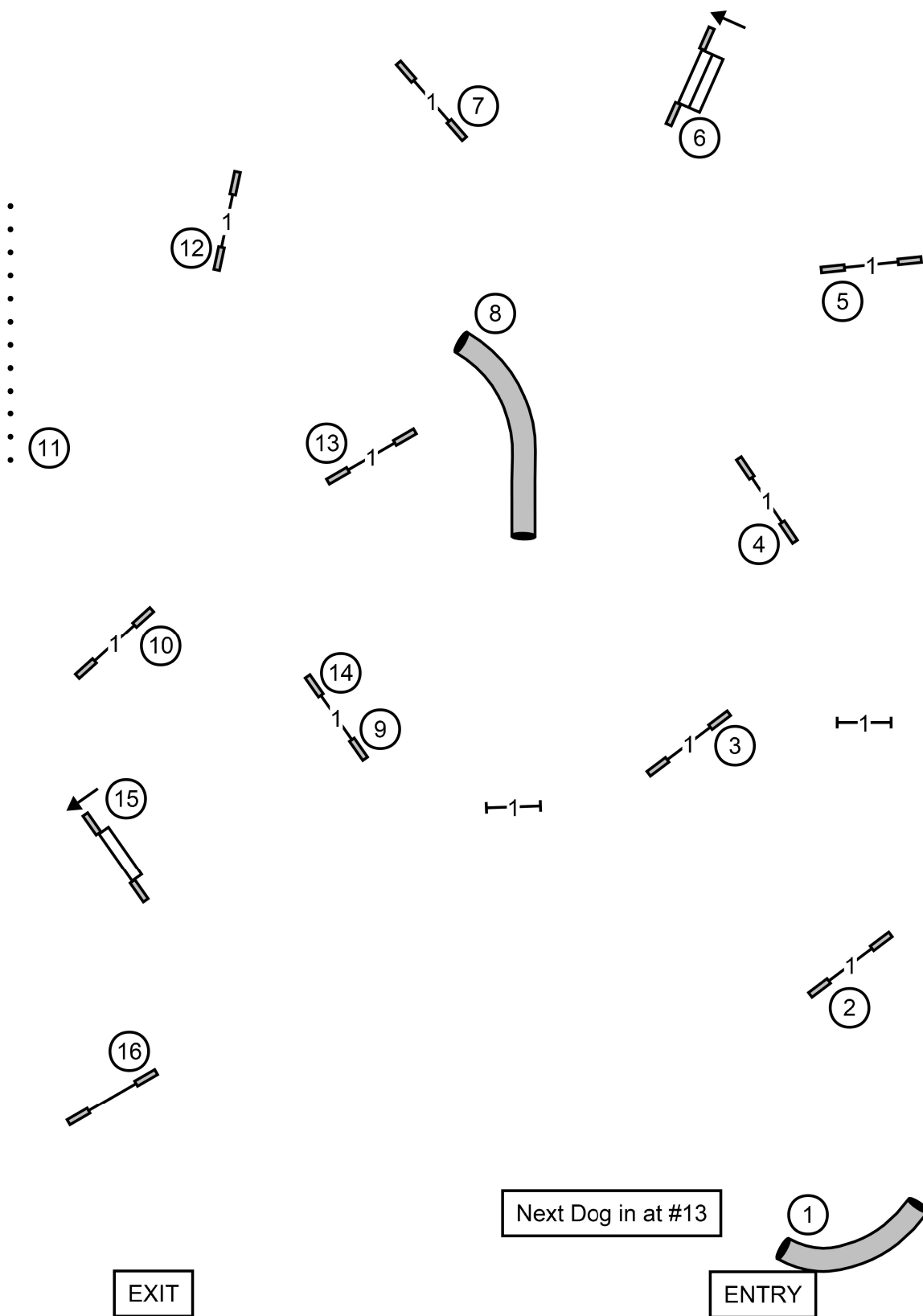

Sunday - March 14, 2021
Judge: Debby Wheeler

OPEN JWW
Keeshond Club of Southern Ca

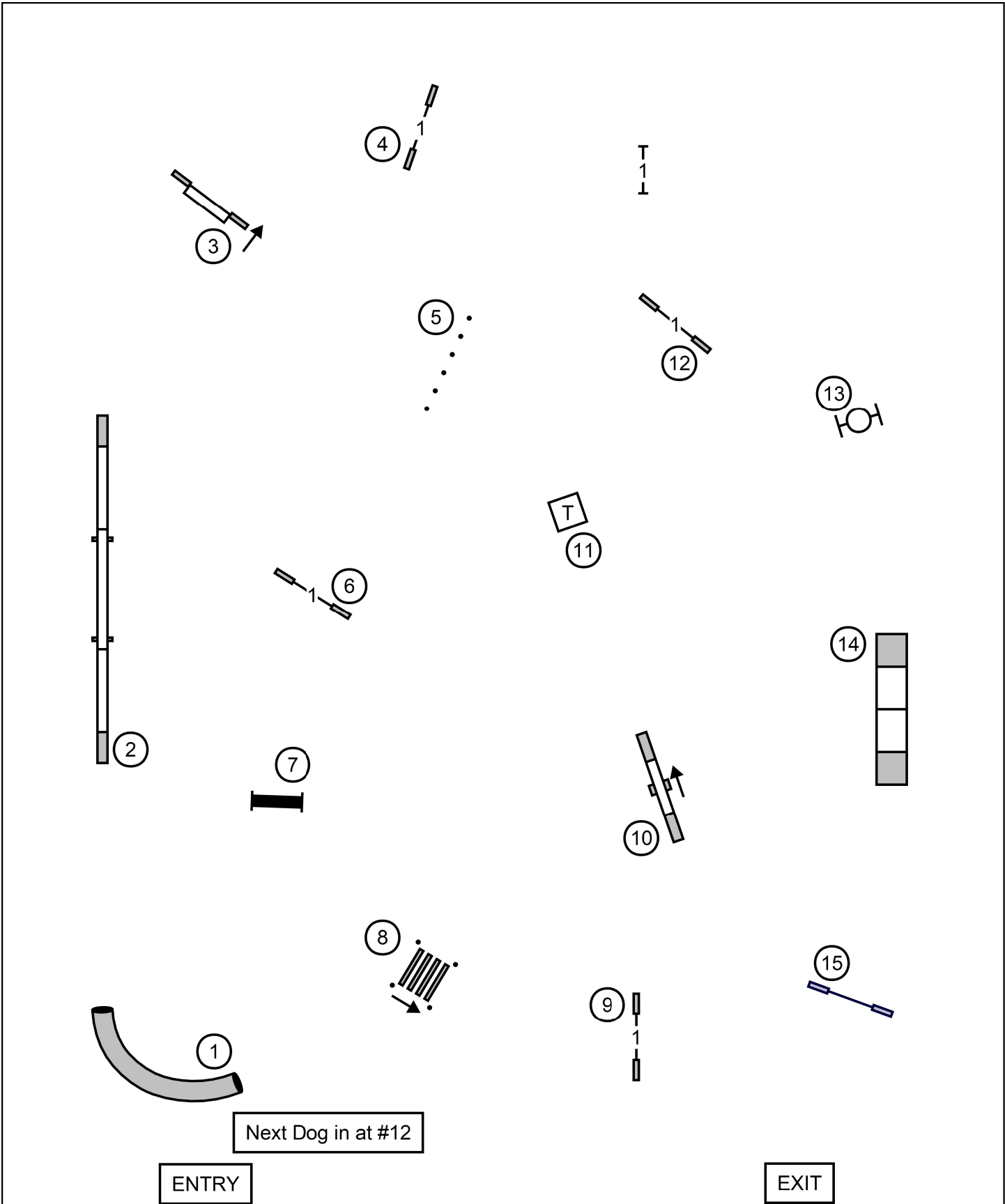

Sunday - March 14, 2021
Judge: Debby Wheeler

NOVICE STANDARD
Keeshond Club of Southern Ca

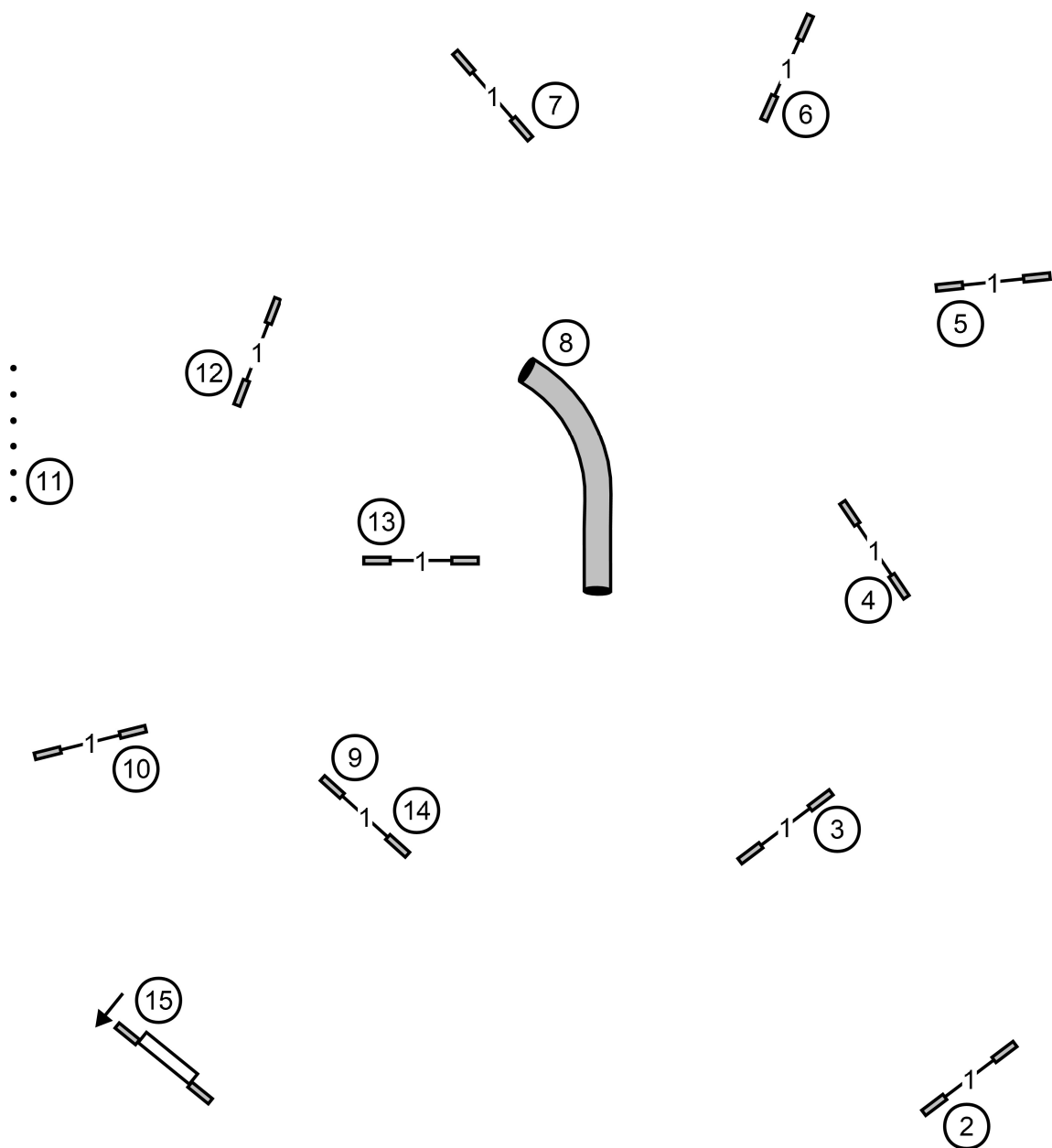

Sunday - March 14, 2021
 Judge: Debby Wheeler

NOVICE JWW
 Keeshond Club of Southern Ca

Keeshond Club of Southern California

Saturday & Sunday March 13 & 14, 2021

Trial Hours 6:00am –5:00pm

Judging will commence at 8:00 AM BOTH DAYS

Green Oak Ranch is a private facility – there will be a guard at the gate – tell him/her that you are with agility and they will let you in!

NO ALCOHOL ALLOWED – SMOKING IN DESIGNATED AREA ONLY!

Park in the lot next to the field.

Overflow parking will only be available if the main lot is full!

AGILITY GATE APP – Code 2468

This is an app for your iPhone or iPad and coming soon for Android. With this app you can go to a class and check-in, scratch, let the gate know you are FEO or that you have a conflict. When the class is running you can see who is running in the ring. The running order will update automatically as dogs are checked in, when they run, etc. You can stay in your set-up and keep an eye on the running order to see when you are due up. This will keep groups of people from congregating around the gate and help with social distancing. Open and Novice people can see what classes are running to have a better idea how the show is running. Go to http://dogagility.info/agility_gate to download the app and instructions on how to use it. To get the class information for this show only we will send you the trial code on Thursday. You can download the app before you get the code. Each night the maps will be loaded into the app.

COVID 19

If you are sick or if you know that you have been exposed to COVID-19 or if you are uncomfortable with the precautions we are taking, stay home – **we will give you a full refund.**

TEMPERATURE CHECK

We will be checking temperatures each day. When you arrive, before you unpack, immediately go to the trial secretary's area to get your temperature checked. When it is checked you will be given a wristband. You will not be allowed in the ring without a wristband.

NOTES ABOUT THE SHOW

- Masks **are required at all times**, except when running your dog, when eating or when you are in your car.
- Please be aware of who is around you and practice social distancing.
- We will provide sanitizer for our workers and the restroom, but exhibitors need to bring their own sanitizer.
- Bathrooms will be supplied with sanitizer, paper towels and disinfectant in the stalls. Do not put anything in the toilets besides toilet paper! The sink will have liquid soap. Please wash your hands. The exterior door will be propped open. Please leave it that way.
- Be prepared for the show to run slower than normal.

HERE'S WHAT TO EXPECT:

- Crating - Set-ups are to be 8'-10' apart. There is plenty of room at GOR. Help us make it as safe as possible.
- Maps - maps will be sent to you the evening before each show and will be on the website at the beginning of the judging schedule. Maps will be put on the Agility Gate app. Maps will be posted on the trailer at the show so you can take pictures of them. We will not have any printed maps available.
- Briefings – We will have a short briefing at the beginning of each group
- Measuring – there will not be any measuring of dogs at this trial.
- Walk-throughs – We will be using the **conveyor belt** system for walk-thrus.

- a. Handlers will line up outside the ring 6 ft from each other, first person starts walking, once that person passes the second obstacle the next person starts walking and this continues down the line.
 - b. Do not stop or retrace your steps while walking the course. When you reach the end of the course, return to the line and walk again.
 - c. Repeat this walking process as many times as you want. We have heard that, 50 people can walk a standard course in 15 minutes.
 - d. **Walk while the game or other group is running. When the other ring is done, we will have another 15 minutes of walk-thru time – please allow the people that were running in the other ring (or were working) to have precedence at this time!**
- Gate Steward – will be using the Agility Gate app. You can do everything on the app except move your dog around if you have multiple dogs in one jump height. The gate steward must do that at the gate.
 - Ring Gates – we will have gates at this trial.
 - Masks– you can remove your mask when you are in the ring. At the end of your run, put your dog's leash on inside of the ring. We will have an area marked off outside the exit gate where you can put on your mask – **replace your mask before you leave this area!**
 - Leashes – **We will have a leash runner.** The leash runner will transport the leashes with a leash grabber that will be sprayed with disinfectant. You can also choose to keep your leash on your body.
 - Results – will be posted on the trailer.
 - Ribbons – will not be self-serve. There will be a ribbon station at the trial secretary's table with a person handing out ribbons and labels. Please line up 6' apart to get your ribbon.

WORKERS:

All worker stations will be equipped with sanitizer, gloves, and disinfectant.

All workers must use their own chair.

Timer/ scribe, gate steward, trial secretary, judge and ribbon areas will be taped off 6' in each direction.

- Jump Setters – can choose to wear gloves or use sanitizer before they pick up and after they put down a jump bar
- Timers and scribes will sit 6' apart. Their area will be taped off so no one can get within 6' of them. Please do not bother the timer/scribe. When finished they will wipe down the timer and table with disinfectant
- Gate Stewards will have their area taped off so no one can get within 6' of them.

Schedule of Events

Thank you for your entry. This is the second confirmation of your entry into the Keeshond Club of Southern California agility trials on Mar 13 & 14, 2021. Please check your confirmation carefully. If there are any errors, please contact Brenda at agilesam@gmail.com If you need to make corrections, please put "KCSC" in your subject line.

This judging schedule and the running order (contingent on move-ups not received) are on the website, www.LyndaTjarksAgility.com. They will be with the listing for the club under •Upcoming Events•

WAIT LIST

We have a waiting list for both days. If you pull your dog for any reason, **and there is someone to take your place**, you will receive a full refund for the class(es) you pull. All waitlist pulls must be received by **Monday Mar 8**. Email Brenda at agilesam@gmail.com if you want to pull your dog!

NOVICE AND OPEN COMPETITORS

If you have any questions or need help with anything, please come to the score table and someone there will be happy to help you. If this confirmation is confusing to you and you need some further explanation e- mail agilesam@gmail.com and Brenda will help you make sense of it.

MOVE-UPS

All pre-show move ups must be received by **6pm, Monday, Mar 8**. The AKC requires move-ups to be in writing. You may send an email for a move-up to Brenda at agilesam@gmail.com with your name, your dog's call name, the

name & date of the trial and what class you want the dog to be moved to. If you miss the deadline for move-ups, you may move your dog up the first day of the show for any **subsequent** days even if you are not showing a dog that day. In addition, a friend may do the move-up for you if you are not there. However, you may not move up the day of the show for that day.

There will be day-to-day move-ups at the show provided the Trial Secretary receives them within 15 minutes after the end of the last class. There will be no move-ups in the morning before the start of the trial.

However, a dog which has been entered in a Novice "A" class for which it is not eligible to be entered in due to class restrictions on the dog or handler may be moved to the Novice "B" class under the following conditions: The request for the move must be in writing and presented to the superintendent or trial secretary at least 30 minutes prior to the start of each trial. The request must state the reason and justification for the move from the Novice "A" class to the Novice "B" class.

DIRECTIONS to Green Oak Ranch, 1237 Green Oak Rd., Vista, CA 92081

Traveling on the 5 from the North or South:

Exit onto CA-78 East toward Vista/Escondido. In 9 mi. take Exit 9 onto Sycamore Ave and turn right. In .8 mi turn right onto Green Oak Rd. The destination is on your right.

Traveling East or West on CA-78:

Take Exit 9 onto Sycamore Ave. Turn south on Sycamore and travel .8 mi. Turn right onto Green Oak Rd. The destination is on your right.

SET UP AND SECURITY:

We are setting up the rings on Friday afternoon. If you would like to come and help set up you must contact Brenda. Only set up crew will be allowed to set their stuff up. No exhibitor set up on Friday. This is a private facility. We will not have security of our own. Leave belongings at your own risk.

RV PARKING:

There are a limited number of RV parking spots available at this site. RV hookup sites (water and power) are \$40/night these are located a short walk from the field. RV dry camping is \$25/night. Dry camping will be in the overflow parking area. There is a dump station on site. Contact Brenda (agilesam@gmail.com) if you want to park overnight.

JUDGE:

Debby Wheeler - Saturday & Sunday - All Classes

MEASURING:

We will not be measuring dogs at this trial.

CHECK-IN AND RUNNING ORDERS:

Listed below are arrival times for each day. Start times are listed for each day.

NOTE: **Do not arrive before your listed time.** When you are done running your classes for the days – PLEASE leave as soon as you are done running so we can minimize the number of people at the site at the same time.

WALK THE COURSES WHILE THE OTHER COURSE IS RUNNING!

When you are done running the first class, walk in the other ring. This will help make the trial run faster.

| |
|--|
| <p>Both days are one judge, two ring trials A, B and Preferred will run concurrently in all Classes All classes will run small to tall (Ex/Master within the groups)</p> |
|--|

| SATURDAY | |
|---|--|
| First dog on the line at 8:00 AM | |
| SATURDAY ARRIVAL TIMES | SATURDAY RUNNING ORDER |
| ALL FAST – 7:15 AM | walk/run FAST in the STD ring |
| Ex/Master 4 - 16" – 8:30 AM | walk/run Excellent/Master JWW 4-16" |
| Ex/Master 20 - 24" – 11:30 AM | walk/run Excellent/Master STD 4-16" |
| Open - 1:00 PM | walk/run Excellent Master JWW 20 -24" |
| Novice - 2:00 PM | walk/run Excellent/Master STD 20 -24" |
| | walk/run Open JWW |
| | walk/run Open STD |
| | walk/run Novice JWW |
| | walk/run Novice STD |
| SUNDAY | |
| First dog on the line at 8:00 AM | |
| SUNDAY ARRIVAL TIMES | SUN RUNNING ORDER |
| ALL T2B - 7:15 AM | Walk/run T2B in the JWW ring |
| Ex/Master 4 - 16" – 8:45 AM | walk/run Excellent/Master STD 4-16" |
| Ex/Master – 20 - 24" – 11:00 AM | walk/run Excellent/Master JWW 4-16" |
| Open – 1:00 PM | walk/run Excellent/Master STD 20 - 24" |
| Novice - 2:00 PM | walk/run Excellent/Master JWW 20 - 24" |
| | walk/run Open STD |
| | walk/run Open JWW |
| | walk/run Novice STD |
| | walk/run Novice JWW |

Veterinarian:

Note: listing of veterinarian is not an endorsement.

Veterinary Specialty Hospital North County 7.6 miles from site

2055 Monteil Rd., San Marcos CA 92069

760-466-0600

OPEN - 24 hours a day, 365 days a year for emergency services

Directions to Vet: Go south on Sycamore Ave Merge onto CA-78 E . In 6.2 mi take Nordahl Rd exit 15. Turn Left onto Nordahl Rd. Turn right to Monteil Rd. 2055 Monteil Rd is on the Right.

WORKERS: THANK-YOU, THANK-YOU, THANK-YOU

Pam Metzger will contact you separately regarding your assignments. **NO FOOD WILL BE SERVED!**

Workers will earn vouchers (dependent on class size) for use at future trials. These vouchers are non-transferable and expire in one year. If you can work contact Pam at K9Volunteers@rocketmail.com. **You must have a dog entered to volunteer.**

JUDGING PROGRAM

(Contingent Upon Move-Ups Not Yet Received)

| <u>Day</u> | <u>Group</u> | TOTAL of All Groups | STANDARD | | JWW | |
|------------|----------------|---------------------------|----------------|---------------------------|----------------|---------------------------|
| | | | <u>Entered</u> | (4,8,12,16,20,24,24C) | <u>Entered</u> | (4,8,12,16,20,24,24C) |
| Sat | Excellent | 204 | 88 | (1, 25, 13, 23, 22, 4, 0) | 90 | (1, 27, 13, 23, 22, 4, 0) |
| | Ex/Master FAST | | 26 | (0, 2, 6, 12, 5, 1, 0) | 0 | (0, 0, 0, 0, 0, 0, 0) |
| | Open FAST | | 7 | (0, 0, 2, 0, 5, 0, 0) | 0 | (0, 0, 0, 0, 0, 0, 0) |

| | | | |
|-------------------|------------|------------------------------|------------------------------|
| Novice FAST | | 12 (0, 3, 1, 2, 6, 0, 0) | 0 (0, 0, 0, 0, 0, 0, 0) |
| Open | 42 | 21 (0, 2, 7, 3, 9, 0, 0) | 14 (0, 2, 7, 2, 3, 0, 0) |
| Novice | 29 | 6 (0, 0, 1, 2, 3, 0, 0) | 11 (0, 0, 1, 2, 8, 0, 0) |
| Total Runs | 275 | 160 | 115 |
| Total Dogs | 122 | | |
| | | | |
| Sun Excellent | 175 | 87 (1, 25, 15, 22, 20, 4, 0) | 88 (1, 25, 16, 22, 20, 4, 0) |
| Open | 29 | 18 (0, 2, 6, 2, 8, 0, 0) | 11 (0, 2, 6, 1, 2, 0, 0) |
| Novice | 23 | 9 (0, 2, 1, 3, 3, 0, 0) | 14 (0, 2, 1, 3, 8, 0, 0) |
| T2B | 48 | 0 (0, 0, 0, 0, 0, 0, 0) | 48 (0, 5, 11, 16, 15, 1, 0) |
| Total Runs | 275 | 114 | 161 |
| Total Dogs | 116 | | |

Lynda Tjarks
Agility Trial Secretary