

Sunday - April 11, 2021
 Judge: Debby Wheeler

TIME 2 BEAT
 Northern California Pug Club

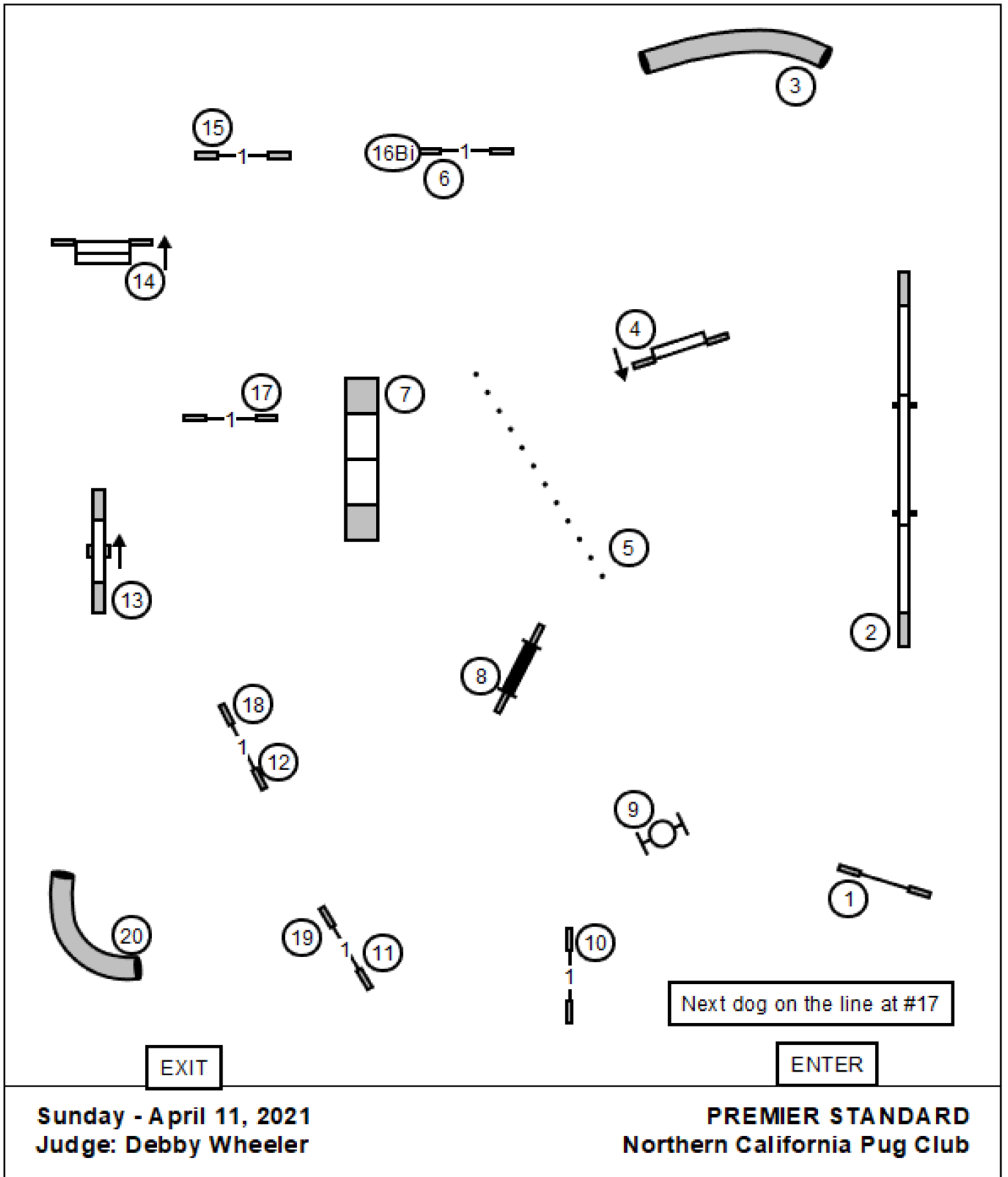

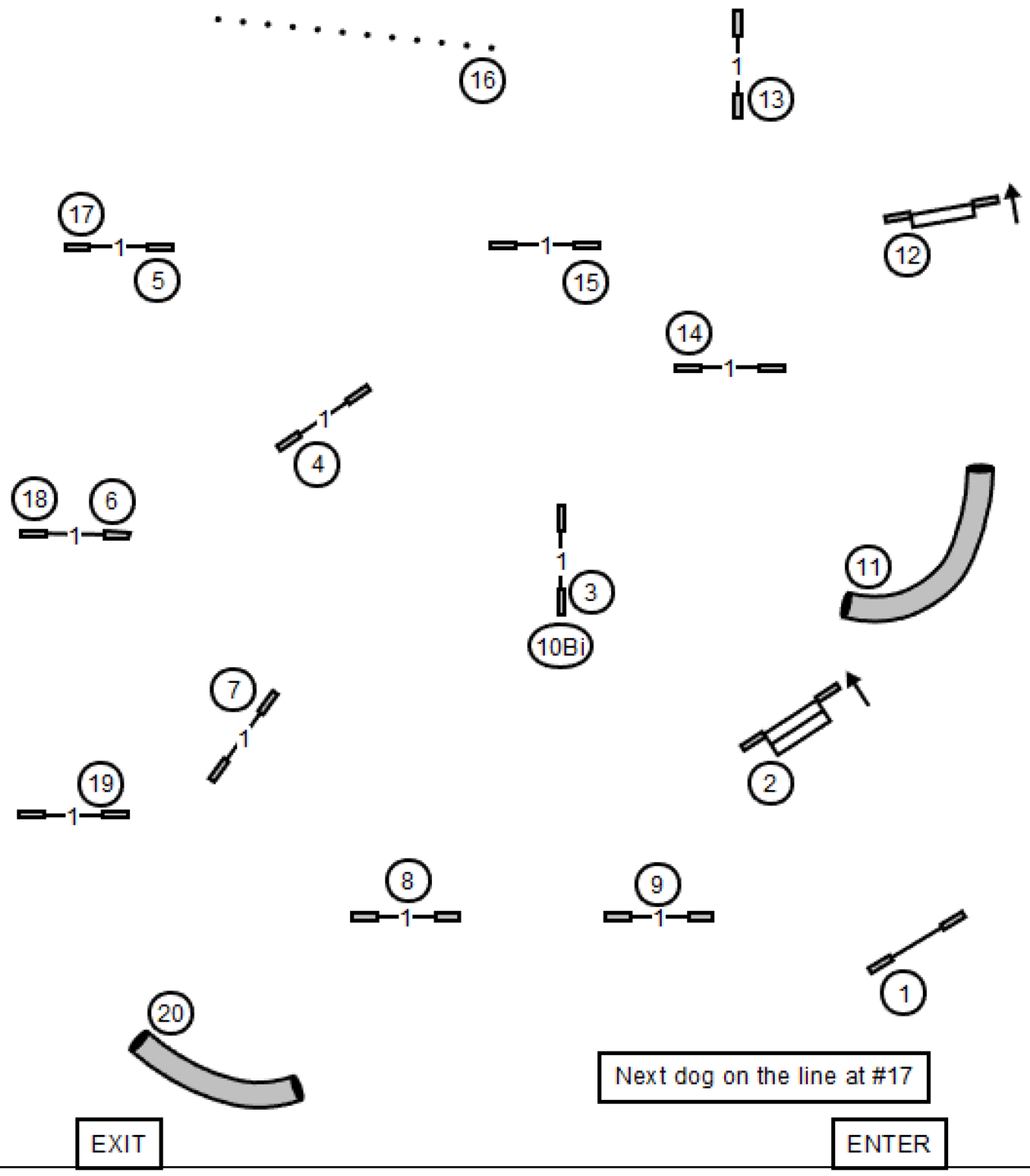

Sunday - April 11, 2021
 Judge: Debby Wheeler

PREMIER JWW
 Northern California Pug Club

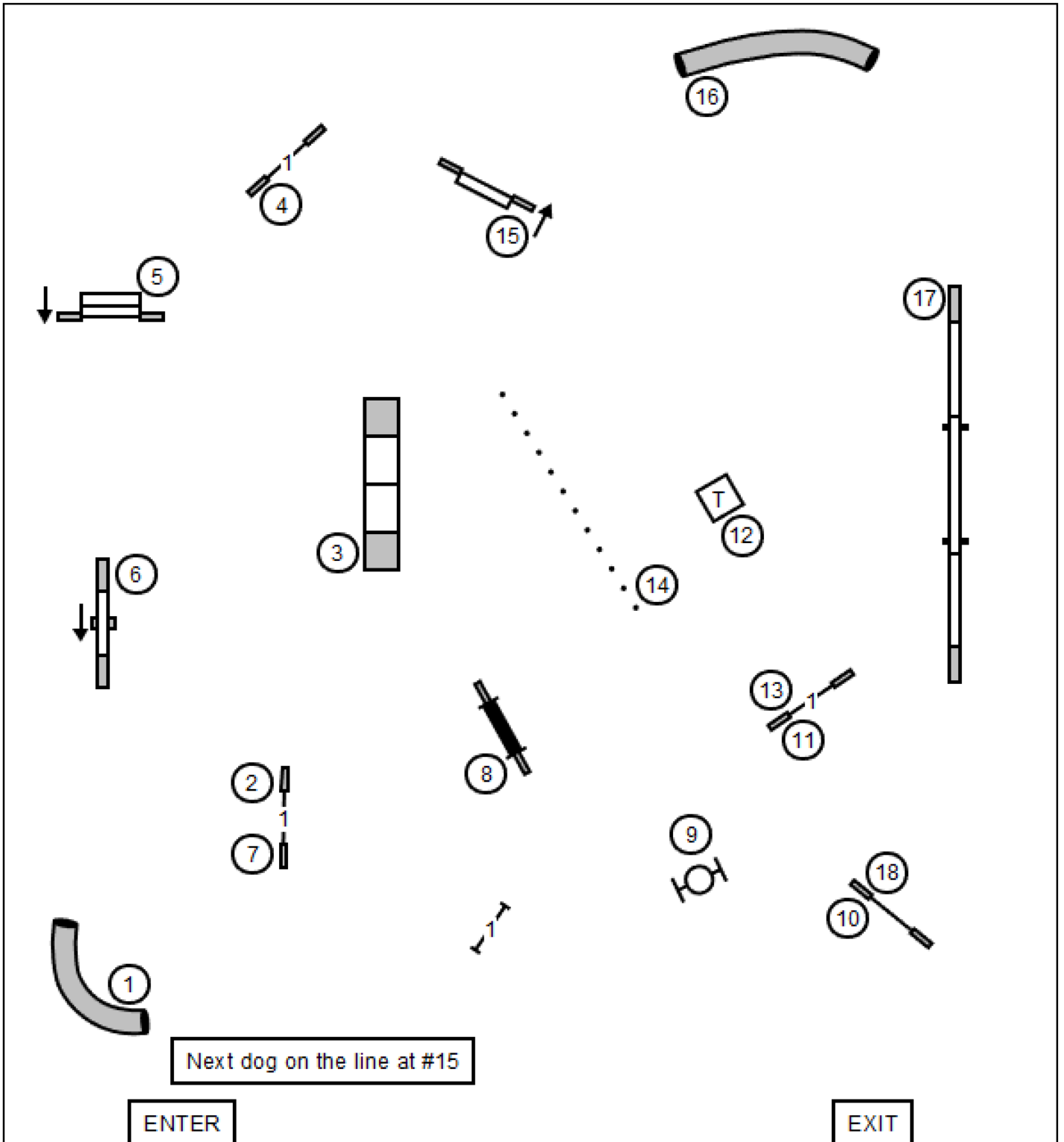

Sunday - April 11, 2021
 Judge: Debby Wheeler

EXCELLENT MASTER STANDARD
 Northern California Pug Club

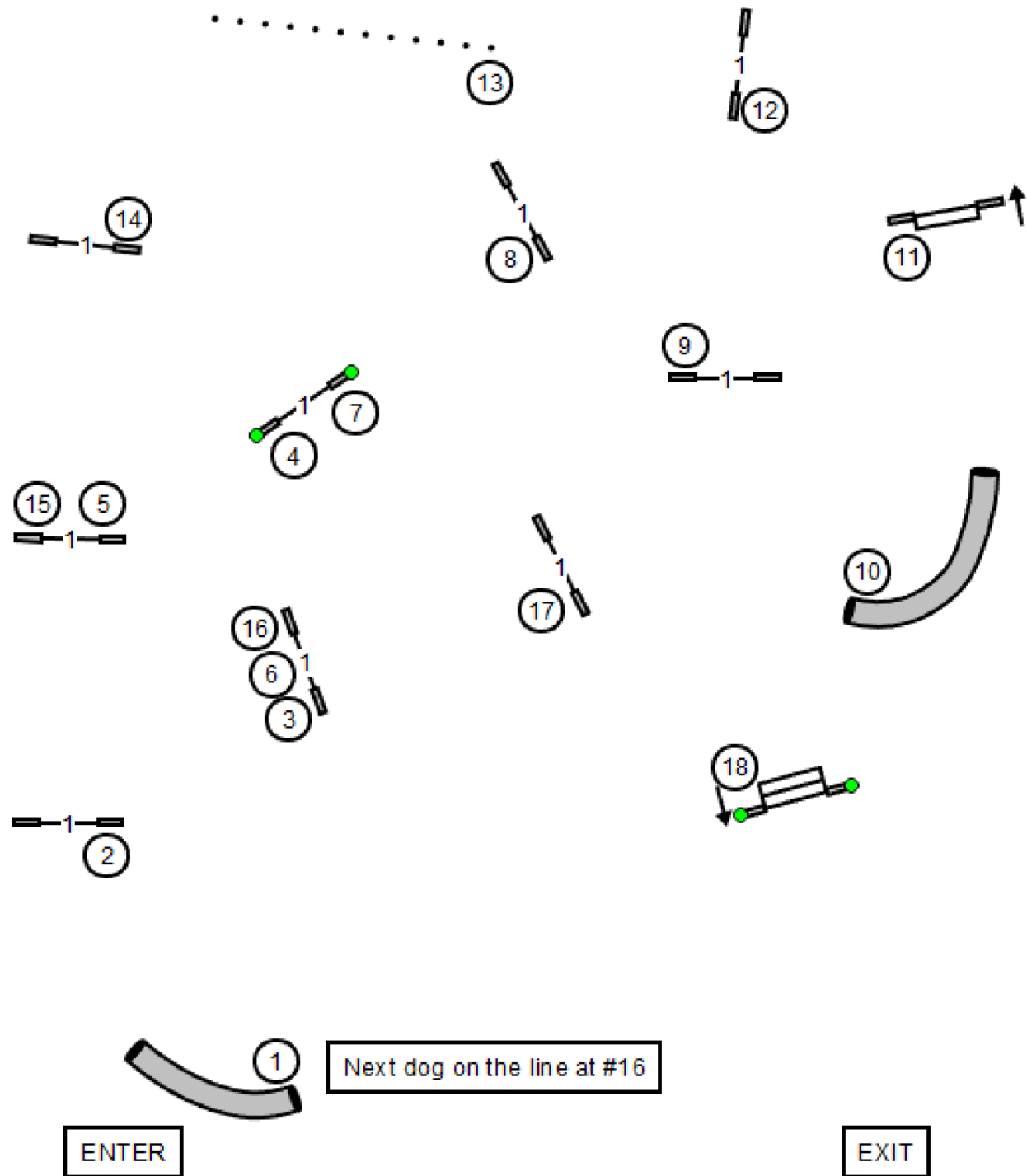

Sunday - April 11, 2021
 Judge: Debby Wheeler

EXCELLENT MASTER JWW
 Northern California Pug Club

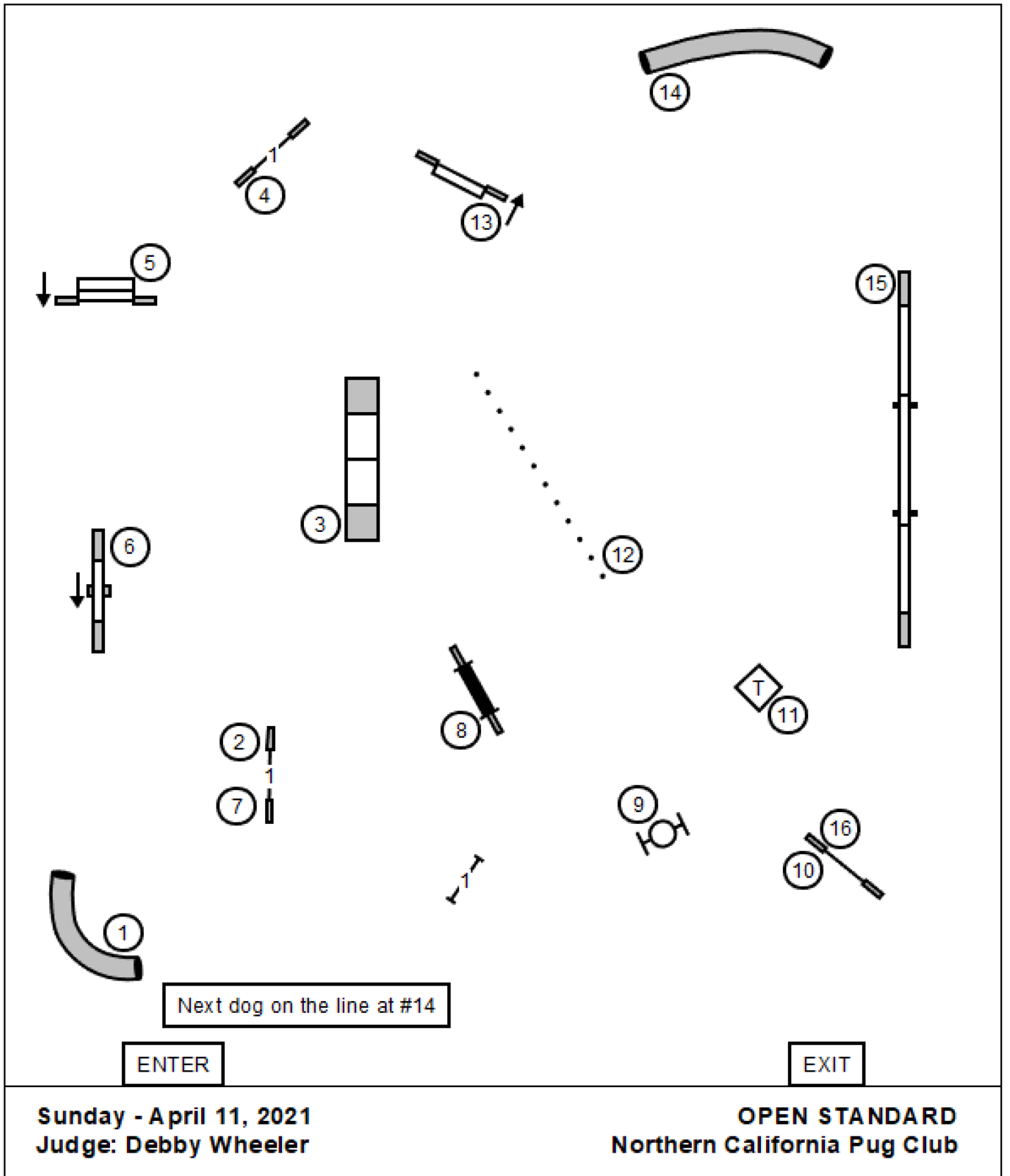

Sunday - April 11, 2021
 Judge: Debby Wheeler

OPEN STANDARD
 Northern California Pug Club

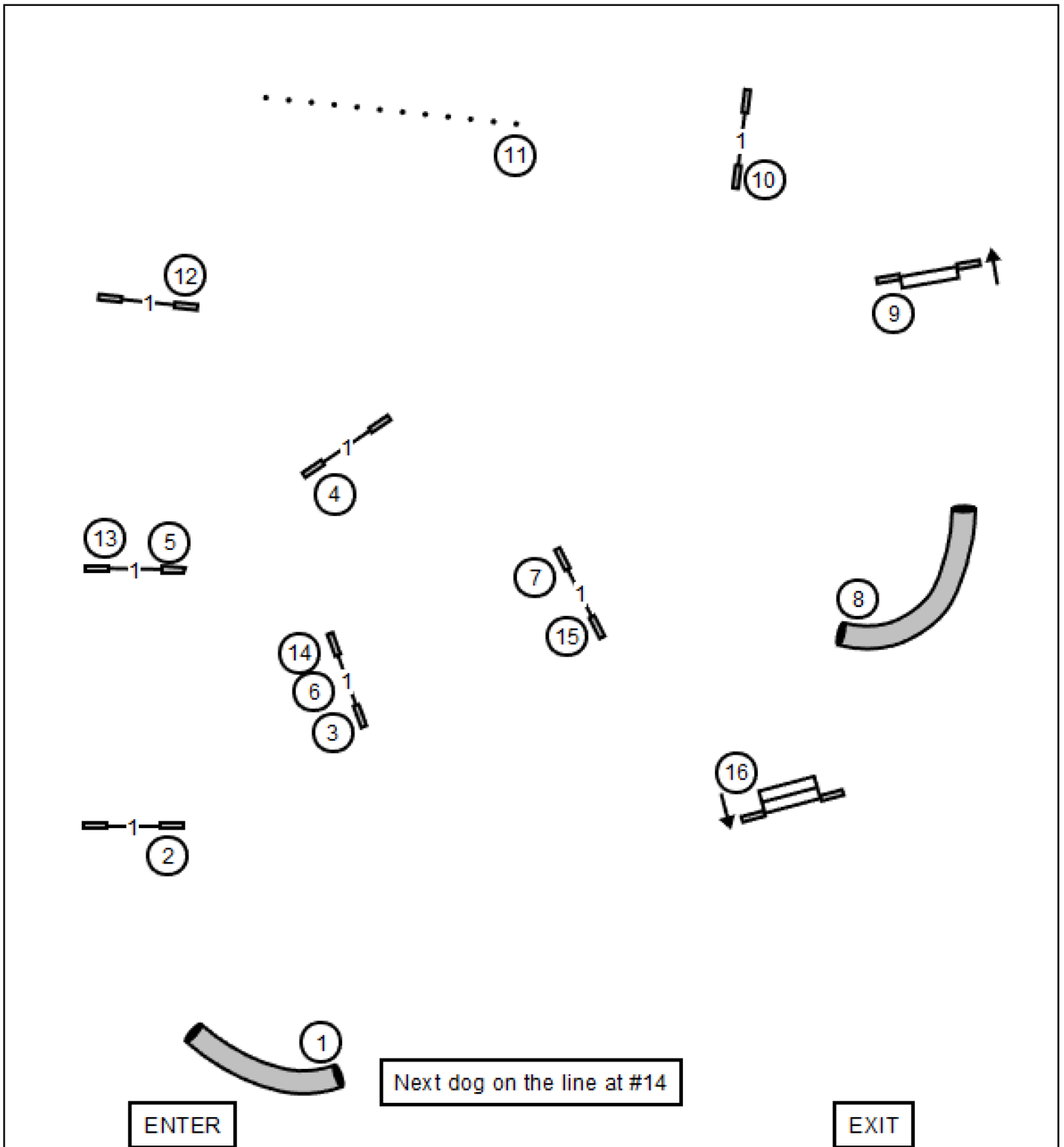

Sunday - April 11, 2021
 Judge: Debby Wheeler

OPEN JWW
 Northern California Pug Club

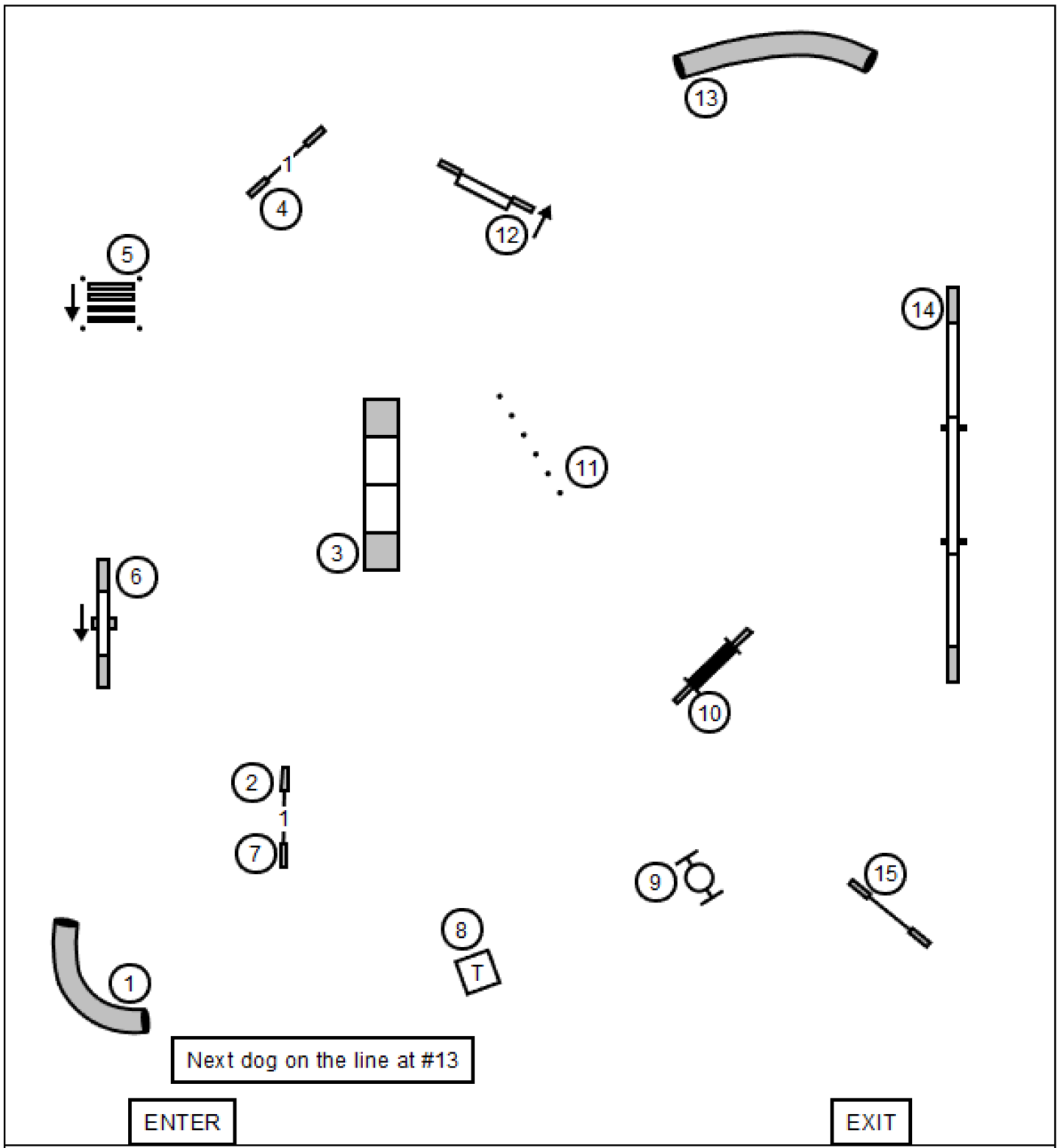

Sunday - April 11, 2021
 Judge: Debby Wheeler

NOVICE STANDARD
 Northern California Pug Club

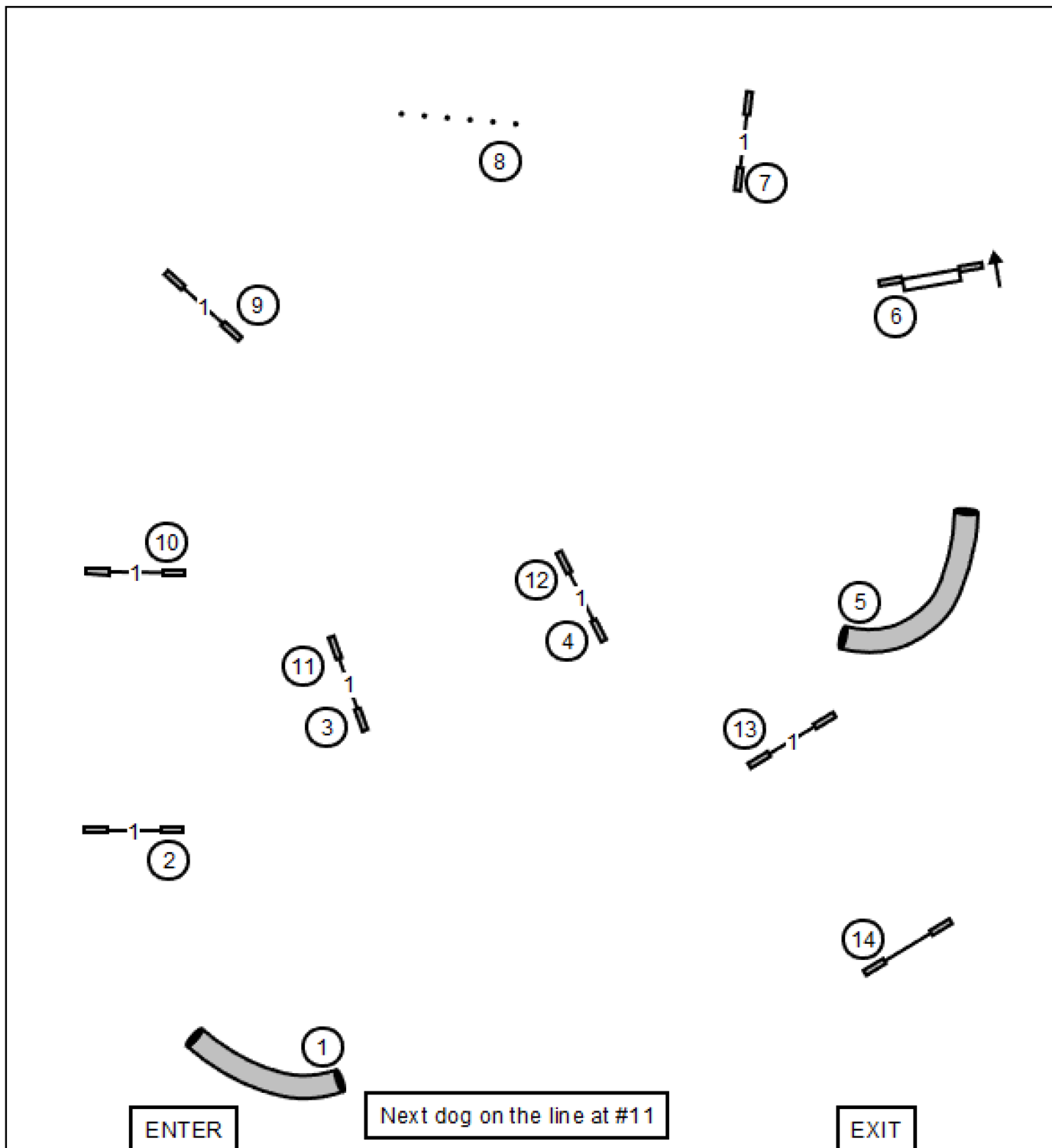

Sunday - April 11, 2021
 Judge: Debby Wheeler

NOVICE JWW
 Northern California Pug Club

Northern CA Pug Club Agility Trials

Friday, Saturday and Sunday April 9-11, 2021

Trial Hours 7:00 –4:00pm

Judging will commence at 9:00 am on Friday and at 8:00am Saturday and Sunday

IMPORTANT!!

Please remember that everyone has NOT had a vaccine yet even if you have. Please keep 6 ft distance between yourself and others. Be considerate of others.

SYCAMORE LANE KENNEL RULES

PARKING

There is a 5.00 parking charge PER DAY. It pays for the parking attendants required by the site.

GRASS

We are not allowed to potty our dogs on the grass.

MATS

All mats must be picked up each night so as not to kill the grass.

POND

Dogs are not allowed to swim in the pond. No humans either.

VINEYARD

We are not allowed to walk dogs in the vineyard.

RV PARKING

A heads up to watch the top of your RV around the tight turns into the lot. There are some low hanging branches.

Thank you for your entry. This is the last confirmation of your entry into the Northern CA Pug Club Agility Trials Apr 9-11, 2021.. Please check all your dog's information in your confirmation carefully. If there are any errors **DO NOT HIT REPLY**, instead please contact Nicole Young at 916-715-0477 or email her at Ltapentries@gmail.com . If you need to make corrections, please put "NCPC" in your subject line.

COVID 19

If you are sick or if you know that you have been exposed to COVID-19 or if you are uncomfortable with the precautions we are taking, stay home – **we will give you a full refund.**

TEMPURATURE CHECK

We will be checking temperatures each day. When you arrive, before you unpack, immediately go to the trial secretary's area to get your temperature checked. When it is checked you will be given a wristband. You will not be allowed in the ring without a wristband.

AGILITY GATE APP – TRIAL CODE 2468

Go to http://dogagility.info/agility_gate to download the app and instructions on how to use it. Each night the maps will be loaded into the app.

NOTES ABOUT THE SHOW

- Masks/face coverings are required at all times, except when running your dog, when sitting under your ez-up or when you are in your car.
- Please be aware of who is around you and practice social distancing.
- We are not providing any hospitality. Workers need to bring their own food and drinks.
- We will provide sanitizer around the show area and in the restrooms,
- PPE – please take any personal protection equipment you use home with you. Do not put it in the trash cans. Bathrooms will be supplied with sanitizer, paper towels and disinfectant in the stalls. Do not put anything in the toilets besides toilet paper! The sink will have liquid soap. Please wash your hands. The exterior door will be propped open. Please leave it that way.

- Be prepared for the show to run slower than normal.
- **PLEASE SET UP WITH A MINIMUM OF 8' BETWEEN TENTS. Plenty of room, no need to be close to each other.**

HERE'S WHAT TO EXPECT:

- Crating - Set-ups are to be at least 8' apart. There is plenty of room. Help us make it as safe as possible.
- Maps - maps will be sent to you the evening before each show and will be on the website at the beginning of the judging schedule. Maps will be sent at 6:00pm BUT onsite and hotel Wi-Fi is slow and can take up to 2 hours to send. Maps will be put on the Agility Gate app. Maps will be posted at the show so you can take pictures of them. We will not have any printed maps available.
- Gate Steward – will be using the Agility Gate app. You can do everything on the app except move your dog around if you have multiple dogs in one jump height. The gate steward must do that at the gate.
- Masks/face coverings – you can remove your mask/face covering when you are in the ring. At the end of your run, put your dog's leash on inside of the ring. We will have an area marked off outside the exit gate where you can put on your mask – replace your mask before you leave this area!

THE JUDGING SCHEDULE IS UP ON MY WEBSITE, www.LyndaTjarksAgility.com if there is something here that you cannot read go to the website for a judging schedule in PDF. Go to "Upcoming Events", scroll down to the date/club and you will find the judging schedule

THE RUNNING ORDER IS UP ON MY WEBSITE, www.LyndaTjarksAgility.com . This is the list of competitors in the order that they will run within their class and not the order the classes will run. Go to "Upcoming Events", scroll down to the date/club and you will find the running order.

NOVICE AND OPEN COMPETITORS, if you have any questions or need help with anything please come to the score table and someone there will be happy to help you. If this confirmation is confusing to you and you need some further explanation, contact Nicole Young at 916-715-0477 or email her at Ltapentries@gmail.com and she will help you make sense of it. If you have conflicts when running your dog or any problems at the show come to the secretary table and we will help you.

MOVE-UPS: All pre-show move ups must be received by 6pm, Monday, April 5. The AKC requires move-ups to be in writing. You may send an email for a move-up to Ltapentries@gmail.com with your name, your dog's call name, the name & date of the trial and what class you want the dog to be moved to. If you miss the deadline for move-ups, you may move your dog up the first day of the show for any **subsequent** days even if you are not showing a dog that day. In addition, a friend may do the move-up for you if you are not there. However, you may not move up the day of the show for that day.

There will be day-to-day move-ups at the show provided the Trial Secretary receives them within 15 minutes after the end of the last class. **There will be no move-ups in the morning before the start of the trial.**

However, a dog which has been entered in a Novice "A" class for which it is not eligible to be entered in due to class restrictions on the dog or handler may be moved to the Novice "B" class under the following conditions: The request for the move must be in writing and presented to the superintendent or trial secretary at least 30 minutes prior to the start of each trial. The request must state the reason and justification for the move from the Novice "A" class to the Novice "B" class.

DIRECTIONS TO SHOW: Sycamore Lane Kennels, 5111 W. Sargent Rd, Lodi, CA 95242

From I-5: Take Hwy 12 East toward Lodi, for 1.6 miles to Ray Road. Turn left on Ray Rd. and proceed for 1 mile to curve in road and turn left toward Sycamore Lane Kennels. Follow signs to site.

From HWY 99: Take Hwy 12 exit West (Kettleman Lane) toward Lodi. Go through Lodi about 5 miles to Ray Rd and turn right. Proceed for 1 mile to curve in road and turn left toward Sycamore Lane Kennels. Follow signs to site.

SET-UP ON FRIDAY MORNING:

No set up on Thursday. We are unloading the trailer and setting up rings at 6:30am on Friday. Any help would be greatly appreciated. Be sure and get your set-up vouchers before you leave General set-up is at 7:30am. Please do not put down your stuff before 7:30am if you are not helping to set up the rings.

VOLUNTEERS: THANK-YOU, THANK-YOU, AND THANK-YOU. White boards will be set-up outside of the rings if you have some spare time. Julie O'Rourke and Karen Johnson are our chief ring stewards Volunteers will receive a \$2.00 voucher for each class worked. Volunteers who work the last class of the day will get a \$4.00 voucher. Volunteers, please bring your vouchers and cash them in for a single voucher with the full amount worked for on it before you leave the show. At this time, we will not be feeding workers.

MEASURING:

The judge will not be measuring at this trial.

JUDGE:

Debbie Wheeler: All Classes

CHECK-IN FRIDAY ONLY

This is a one judge, two-ring day
All Classes will run Tall to Small.

FAST check in at 8:30
T2B check in 9:15
Ex/Mas STD check in 10:00
Ex/Mas JWW will follow STD
Premier check in 12:30

FRIDAY RUNNING ORDER

All classes will run Tall to Small. **All FAST classes will walk together, all levels will run in their jump height together.** Starting with FAST in the STD ring we will alternate rings **EXCEPT** for the Ex/Ma STD and JWW classes. The EX/MA STD class will walk/run 24-20" STD, then walk /run 16-4" STD then go to JWW. The EX/MA JWW class will walk/run 24-20" JWW, then walk/run 16-4" JWW then go to the PREMIER classes

Standard Ring

Walk/run FAST
Walk/run Ex/Mas 24-20" STD
Walk/run Ex/Mas 16-4" STD
Walk/run Premier STD

JWW Ring

Walk/run T2B
Walk/run Ex/Mas 24-20" JWW
Walk/run Ex/Mas 16-4" JWW
Walk/run Premier JWW

CHECK-IN SATURDAY:

This is a one judge, two-ring day.
All classes will run Tall to Small.

FAST check in at 7:30
Premier STD check in 8:30
Premier JWW check in 9:00
Ex/Mas STD check in 9:30
Ex/Mas JWW will follow STD
Open check in at 12:30
Novice check-in 1:30

RUNNING ORDER SATURDAY

All classes will run Tall to Small. **All FAST classes will walk together, all levels will run in their jump height together.** Starting with FAST in the STD ring we will alternate rings **EXCEPT** for the Ex/Ma STD and JWW classes. The EX/MA STD class will walk/run 24-20" STD, then walk /run 16-4" STD then go to JWW. The EX/MA JWW class will walk/run 24-20" JWW, then walk/run 16-4" JWW then go to the OPEN classes.

Standard Ring

Walk/run FAST
Walk/run Premier STD
Walk Ex/Mas 24-20" STD
Walk/run Ex/Mas 16-4" STD
Run Ex/Mas 24-4" STD
Walk/run Open STD
Walk/run Novice STD

JWW Ring

Walk/run Premier JWW
Walk Ex/Mas 24-20" JWW
Walk/run Ex/Mas 16-4" JWW
Run Ex/Mas 24-4" JWW
Walk/run Open JWW
Walk/run Novice JWW

CHECK-IN SUNDAY:

This is a one judge, two-ring day.
All classes will run Tall to Small.

T2B check in 7:30
Premier STD check in 8:00
Premier JWW check in 8:15
Ex/Mas STD check in 8:45
Ex/Mas JWW will follow STD
Open check in at 11:30
Novice check-in 12:00

SUNDAY RUNNING ORDER

All classes will run Tall to Small. **All FAST classes will walk together, all levels will run in their jump height together.** Starting with FAST in the STD ring we will alternate rings **EXCEPT** for the Ex/Ma STD and JWW classes. The EX/MA STD class will walk/run 24-20" STD, then walk /run 16-4" STD then go to JWW. The EX/MA JWW class will walk/run 24-20" JWW, then walk/run 16-4" JWW then go to the OPEN classes

Standard Ring

Walk/run Premier STD
Walk Ex/Mas 24-20" STD

JWW Ring

Walk/run T2B
Walk/run Premier JWW
Walk Ex/Mas 24-20" JWW

Walk Ex/Mas 16-4" STD
 Run Ex/Mas 24-4" STD
 Walk/run Open STD
 Walk/run Novice STD

Walk Ex/Mas 16-4" JWW
 Run Ex/Mas 24-4" JWW
 Walk/run Open JWW
 Walk/run Novice JWW

VETERINARIAN ON CALL,

Inclusion of these businesses in this premium is for your convenience and does not constitute a recommendation.

Oakwood Veterinary Hospital.....209-333-7010 Fri/Sat 8am-8pm

18815 N. Lower Sacramento Rd., Woodbridge, CA 95258

Directions: Start out going East on Bennett Valley Rd. Turn slight left onto Maple Ave. Turn left onto Santa Rosa Ave. Approximate distance from fairgrounds to Animal Hospital is 1.5 miles. Go straight on W. Sargent Rd to Davis Rd. Turn left on Davis Rd. Continue to W. Turner Rd. and turn right. Turn left on Lower Sacramento Rd/County Hwy-J10. Vet will be on your left, ARCO station on the right. (about 11 minutes)

All Creatures Veterinary Emergency Clinic209-472-7387 24/7 Emergency

7707 West Lane, Suite A, Stockton, CA 95201

Directions: Go east on W Sargent Rd and turn at first right onto N Ray Rd. Turn left onto CA-12E. Turn right onto Lower Sacramento Rd. Go left onto E 8 Mile Rd. Take first right onto West Ln

DOWNLOAD PREMIUMS AND ENTER ONLINE AT www.lyndatjarksagility.com

**Apr 30-May 2 Golden Gate Pembroke Welsh Corgi Fanciers
 Leone Equestrians - outside
 Judge: Candy Nettles**

JUDGING PROGRAM

(Contingent Upon Move-Ups Not Yet Received)

Day	Group	TOTAL of All Groups	STANDARD			JWW		
			Entered	(4,8,12,16,20,24,24C)		Entered	(4,8,12,16,20,24,24C)	
Fri	Excellent	182	71	(1, 7, 11, 18, 30, 4, 0)	69	(1, 6, 10, 18, 30, 4, 0)		
	Premier	40	21	(0, 4, 3, 8, 3, 3, 0)	19	(0, 1, 4, 8, 4, 2, 0)		
	Open	3	0	(0, 0, 0, 0, 0, 0, 0)	0	(0, 0, 0, 0, 0, 0, 0)		
	Novice	1	0	(0, 0, 0, 0, 0, 0, 0)	0	(0, 0, 0, 0, 0, 0, 0)		
	T2B	28	0	(0, 0, 0, 0, 0, 0, 0)	0	(0, 0, 0, 0, 0, 0, 0)		
	Total Runs	254	92		88			
Total Dogs		77						
Sat	Excellent	175	75	(1, 9, 12, 16, 31, 4, 2)	69	(1, 9, 11, 16, 27, 3, 2)		
	Premier	52	29	(0, 3, 6, 9, 8, 2, 1)	23	(0, 2, 4, 8, 7, 1, 1)		
	Open	18	5	(0, 1, 1, 1, 2, 0, 0)	8	(0, 0, 1, 0, 6, 1, 0)		
	Novice	47	18	(1, 5, 1, 4, 3, 4, 0)	20	(1, 6, 2, 5, 2, 4, 0)		
	Total Runs	292	127		120			
Total Dogs		103						
Sun	Excellent	109	56	(1, 7, 9, 13, 22, 4, 0)	53	(1, 7, 8, 13, 21, 3, 0)		
	Premier	29	15	(0, 2, 3, 5, 3, 2, 0)	14	(0, 1, 4, 5, 3, 1, 0)		
	Open	8	4	(0, 1, 1, 0, 2, 0, 0)	4	(0, 0, 1, 0, 2, 1, 0)		
	Novice	25	12	(0, 3, 1, 4, 2, 2, 0)	13	(0, 4, 2, 3, 2, 2, 0)		
	T2B	30	0	(0, 0, 0, 0, 0, 0, 0)	0	(0, 0, 0, 0, 0, 0, 0)		
	Total Runs	201	87		84			
Total Dogs		75						

<u>Day</u>	<u>Group</u>	FAST							T2B						
		<u>Entered</u>	(4,8,12,16,20,24,24C)						<u>Entered</u>	(4,8,12,16,20,24,24C)					
Fri	Excellent	42	(2, 2, 11, 9, 15, 3, 0)					0	(0, 0, 0, 0, 0, 0, 0)						
	Open	3	(0, 1, 0, 1, 1, 0, 0)					0	(0, 0, 0, 0, 0, 0, 0)						
	Novice	1	(0, 1, 0, 0, 0, 0, 0)					0	(0, 0, 0, 0, 0, 0, 0)						
	T2B	0	(0, 0, 0, 0, 0, 0, 0)					28	(1, 1, 7, 7, 10, 2, 0)						
	Total Runs	46						28							
Sat	Excellent	31	(2, 2, 10, 6, 10, 1, 0)					0	(0, 0, 0, 0, 0, 0, 0)						
	Open	5	(0, 1, 0, 2, 2, 0, 0)					0	(0, 0, 0, 0, 0, 0, 0)						
	Novice	9	(1, 4, 1, 1, 1, 1, 0)					0	(0, 0, 0, 0, 0, 0, 0)						
	Total Runs	45						0							
Sun	T2B	0	(0, 0, 0, 0, 0, 0, 0)					30	(1, 2, 8, 5, 12, 2, 0)						
	Total Runs	0						30							